

Anytime
Continuous Glucose Monitoring System

CT15/CT3 Series Quick Start Guide

Parts

Open both boxes and make sure that you have all of the parts shown below:



Sensor (probe) Transmitter Charging base Charging cable

① Preparations

Step 1 Download the software

- Turn on the mobile Bluetooth
- Download the 'Yuwell Anytime' app from your usual app store
- Follow the prompt to log in



1 Turn on Bluetooth



2 Login

Step 2 Charge the transmitter

- Place the transmitter into the charging base for charging. The white indicator will flash (indicating charging).
- Wait for the indicator to turn blue (indicating full charging) and remove the transmitter.



Remove the transmitter after full charging

Indicator

White indicator flashing: charging
Blue indicator: fully charged

② Connect the device

Step 1 Connect to the transmitter

- Access the 'connect transmitter' page on the app. Select the SN corresponding to the transmitter to complete the connection. Connect the sensor by scanning the QR code on the housing of the sensor.



SNxxxxxxxx

Step 2 Connect to the sensor

- On the App page, scan the QR code on the plastic housing of sensor and enter the initialization countdown mode.

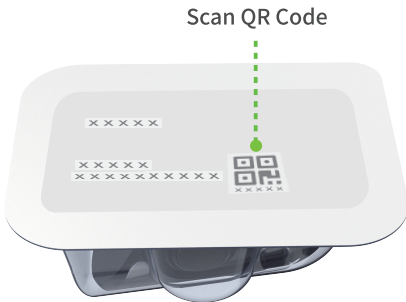

Scan QR Code

③ Implant the sensor

Step 1

- Choose either an upper arm or abdominal insertion site. If an abdominal site is chosen, place the sensor within the dashed areas below.
- Disinfect with alcohol prep pad and air dry it before the next step.

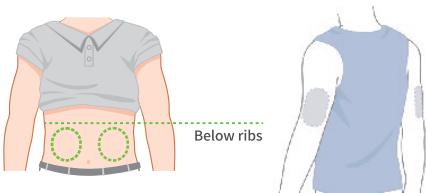

To wear at the upper arm: please select the rear of upper arm side.

Step 2

Do not unlock before applying to the skin

- Tear off two protective films from the orange area.

Tear off protective films

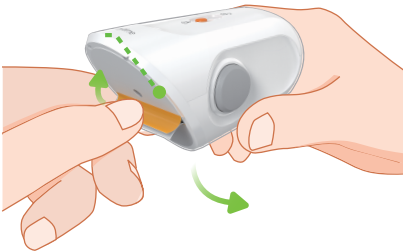

Step 3

Do not unlock before applying to the skin

- Place the sensor tightly against the implantation site.

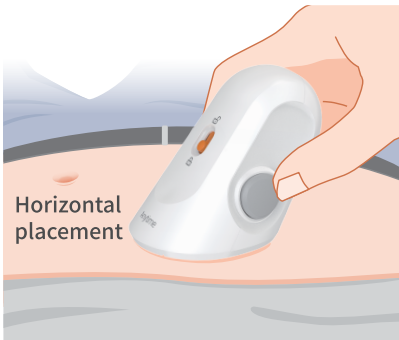

Step 4

- Slide the safety lock to unlock.

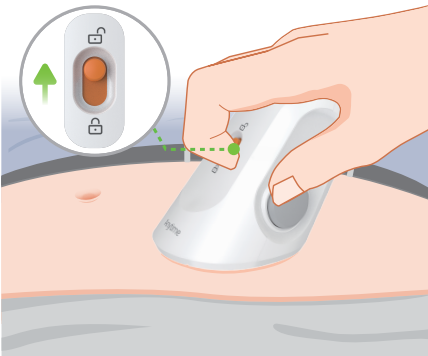

Step 5

- Press the buttons on two sides at the same time until a "click" sound is heard.

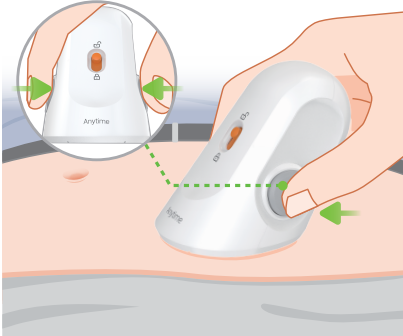

Step 6

- Slowly remove the insertion device part of the sensor to complete the implantation.

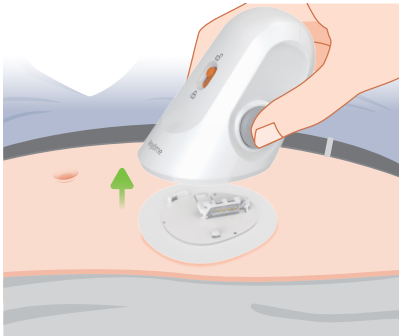

4 Install the transmitter

Step 1 ★ Important steps

- Snap the transmitter onto the sensor according to the angle shown in the following figure.



Step 2

- Firmly pinch the transmitter and sensor as shown in the following figure until a "click" sound is heard.

⚠ Push the transmitter in reverse to verify it is locked.

1

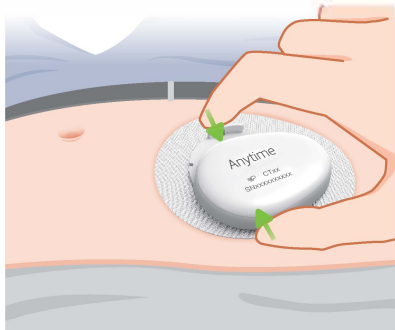

2

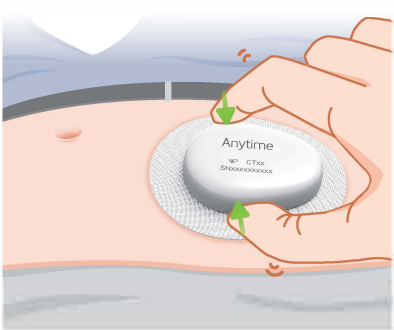

5 Software interface

- The App starts displaying the blood glucose value after initialisation ends.
The initialisation takes **60 minutes**



Stop monitoring and remove the device

- Slowly remove as a whole with the tape and device from the wearing site.
- After removal, force apart the buckle downwards and slide the transmitter open.
- Dispose of the sensor as medical waste.

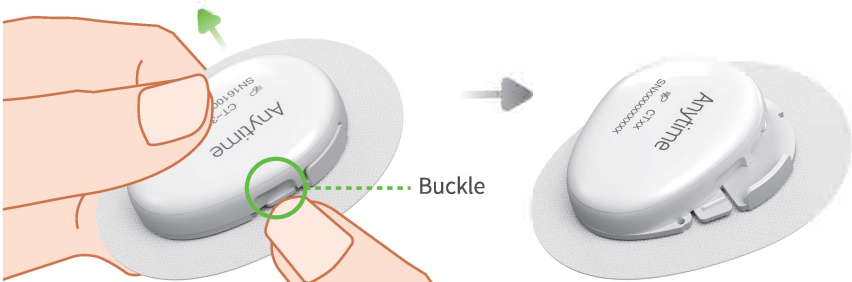

⚠ Do not throw the transmitter by mistake

⚠ The transmitter is immediately charged

ZHEJIANG POCTECH CO., LTD.
Buildings 11 and 12 (North Zone of Floors 2 and 4), No. 1633, Hongfeng Road, Huzhou City, Zhejiang Province
Document No.: A4-CGM14-010
Version No.: V20230610 rev1

Prepared on: 06/10/2023

Importer / Distributor:
Urathon Europe Ltd
Thane House
Hilmarton
Wiltshire
SN11 8SB UK
Tel: 01249 760581
E: sales@urathon.com

EU Representative:
Prolinx GmbH
Brehmstrasse 56
Dusseldorf
40239
Germany